

Little Eagle Lake

LOCATION: Ten miles east of Belzoni, MS, south of Hwy. 12.

SIZE: 700 acres.

DEPTH: Varies from 6 to 8 feet.

AQUATIC VEGETATION: Duckweed.

MAJOR SPORTFISH: Largemouth bass, crappie, bream (bluegill), channel catfish.

OTHER FISH: Bowfin, buffalo, common carp, drum, flathead catfish, green sunfish, gar.

FISH FORAGE: Shad, minnows, sunfish.

VISIBLE COVER: Cypress and black gum.

BOTTOM FEATURES: Underwater snags, stumps, root systems.

FISHING LICENSE: CALL 1-800-5-GO-HUNT

GUIDE SERVICES: CALL 1-800-270-DELTA



MAN-MADE FISH STRUCTURES: None

ACCESS: This lake has one boat ramp which is a fee ramp.



DESCRIPTION: This lake is a cypress black gum swamp totaling 700 acres of which 250 are accessible to fishing. The lake has a minimum size limit on largemouth bass of 20 inches with a 2 bass per day limit.





To Belzoni, MS

Hwy 12

Boat Ramp	
Paved Road	
Flooded Timber	

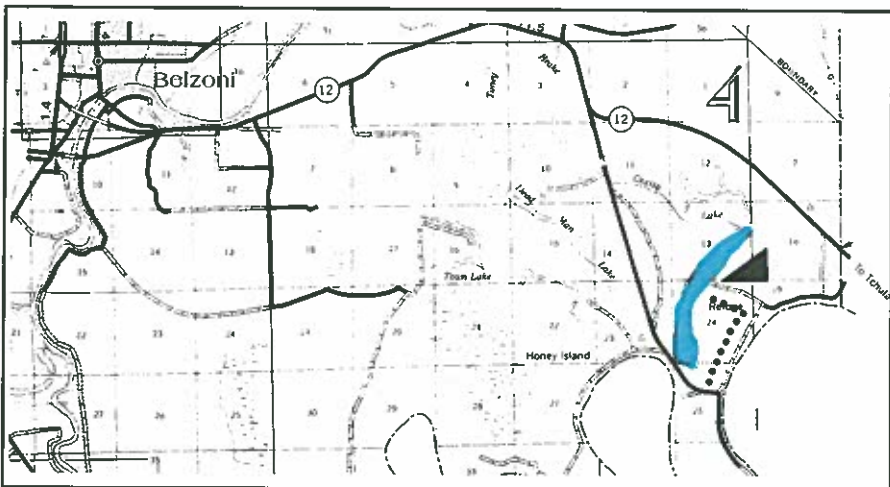
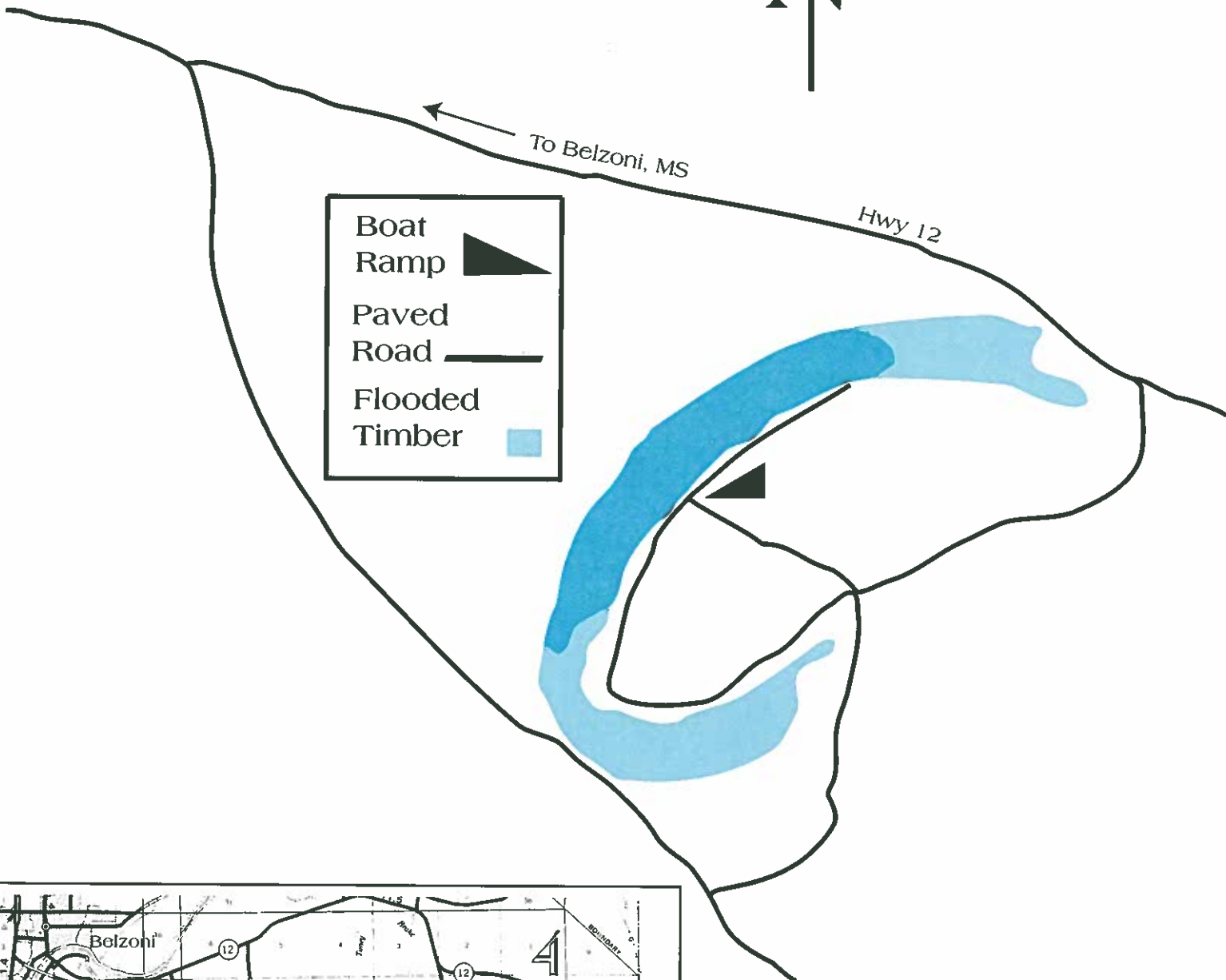

AREA MAP